

PLEATED INSECT SCREEN PS1, PS1 V

1. MEASUREMENT

1.1. Measurement into reveal

The width and the height of the hole clearance
Measurements are taken at three points, the

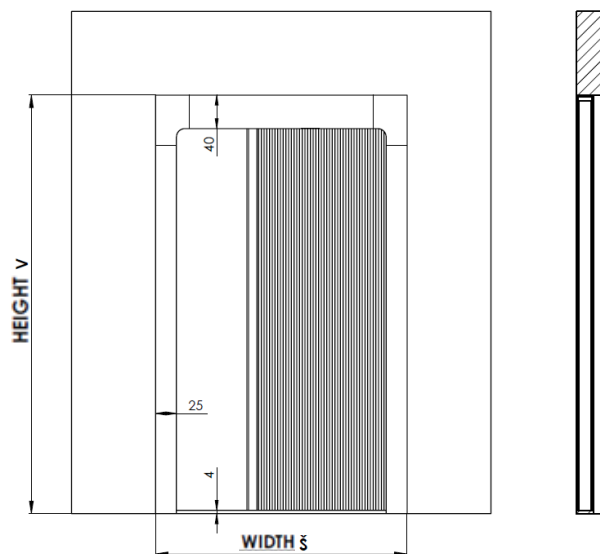

2.1. Measurement on the frame

Outside dimensions of insect screen are measured

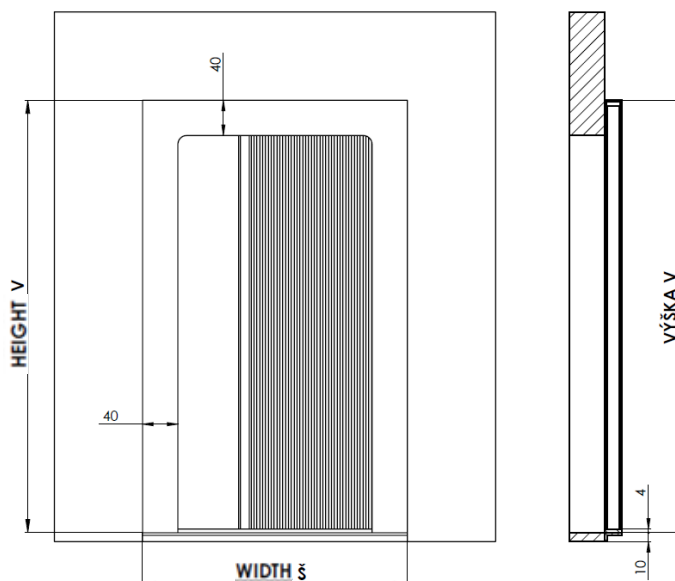

2. ASSEMBLY

2.1. ASSEMBLY INTO REVEAL

2.1.1. Frame installation

Place the plastic components on the upper and lower profile (see the details on below picture). Remove the protection of the double sticker and fix the upper and lower profile in the installation place. Correct any differences in length by sliding the angles pieces along. If you want to screw the lower profile the screws must have a countersunk head! Decide on which side the opening will be placed. Insert side guiding profile into corner component.

First, in the upper profile and consequently to the lower profile. Drill holes for fixing profiles (these holes should correspond with the holes in the vertical profiles). Fix it using the enclosed screws.



2.1.2. Insertion and fastening of insect screen KIT

Insert the net packet inside the upper and lower profiles. Move the net packet towards the side guiding start profile. Insert the screen packet in the side profile until it locks in place (to the stop). Always start the inserting from the bottom.



2.1.3. Tuner insertion

Insert the tuner in the appropriate angles, taking care to ensure that the heads of the tuner screws are always in sight and that the cords remain parallel (not crossed).

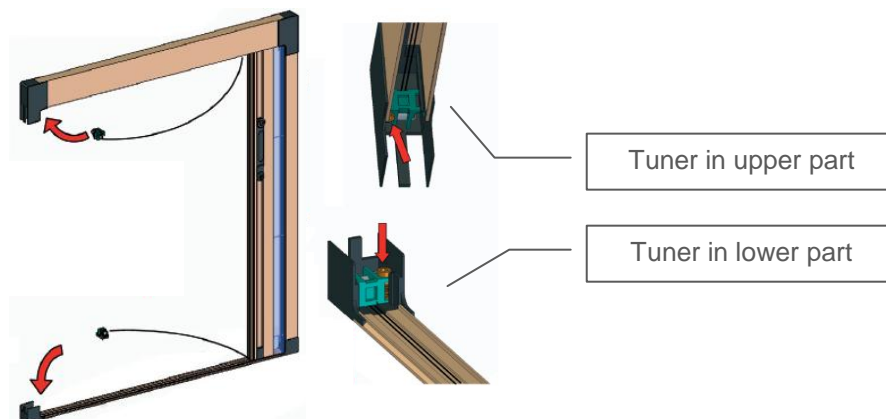

The cords have to lead out of the tuner on the opposite side of screws.

2.1.4. Installation of guiding profile on the opposite site

Insert the side guiding profile on the opposite site in the angles, by inserting the upper part first, then the lower part. Fasten using the screws provided.



2.1.5. Setting of

cords

If necessary adjust the copper screw in tuner with supplied Allen key by turning it either to the left or right to set the tautness of the cords until a smooth flowing movement is obtained and the handle bar KIT is perfectly vertical.

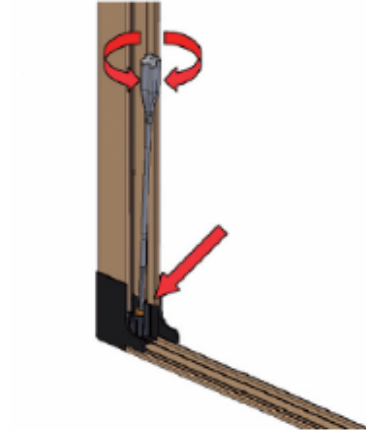
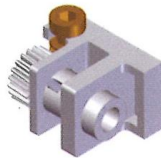

2.1.6. Insert the magnet channel

Check the polarity of the magnet channel and insert the magnet profile on the side profile.

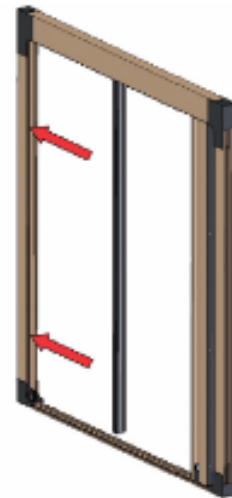

2.1.7. Plastic profile with spring

Insert plastic profile with spring of guides in the top profile KIT. Gently push the plastic part to the upper profile and tighten the screws. Plastic profile needs to elongate.

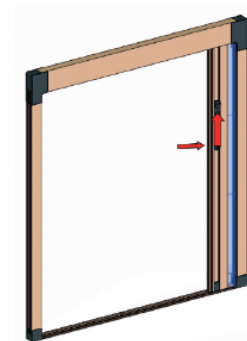

2.1.8. Handle

Insert the handle (optional part) then fastening with the screw. You can conveniently operate without handle.

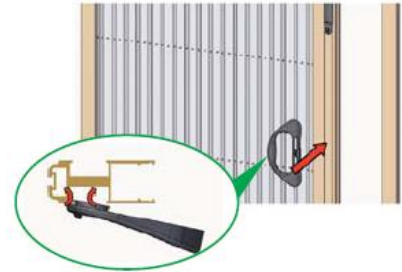

2.1.9. Guard insert

Insert the guard to the bottom frame KIT. For better guidance KIT in bottom profile.



2.1.10. Movement test



2.1.11. Disassembling (for cleaning)

Use the screw until the escaping of the screen pack.

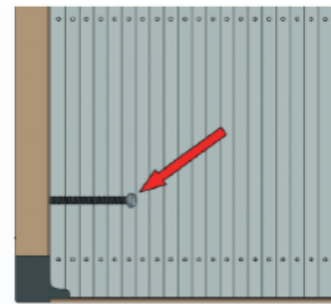

2.2. ASSEMBLY ON THE FRAME

2.2.1. Insert the bottom corner accessory on left „starting profile“.



2.2.2. Insert the top corner accessory on left „starting profile“.



2.2.3. Insert the upper track into the left top corner accessory.

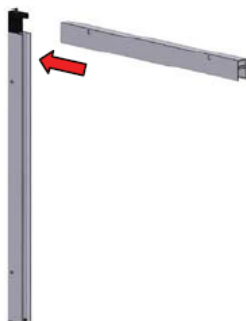

2.2.4. Insert the top right corner component into upper profile.

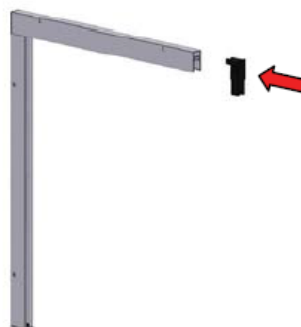

2.2.5. Insert the right guiding profile into the plastic corner component.

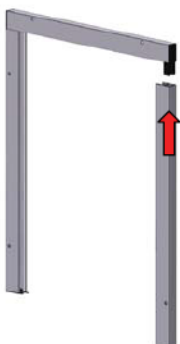

2.2.6. Insert the bottom corner component into the side profile.



2.2.7. Fix the frame on the mounting spot according to pre-drilled holes.

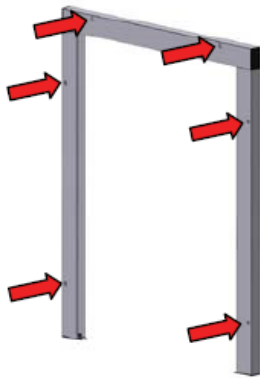

2.2.8. Position the lower profile on the right place of plastic corner components, fix it to the ground or supplied supportive Al profile.

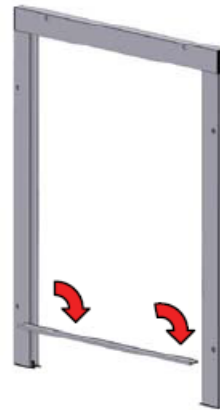

2.2.9. Insert and fix the screen KIT.

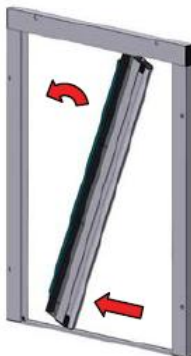

2.2.10. Insert the plastic part at the end of cords into a hole in back part of lower profile.

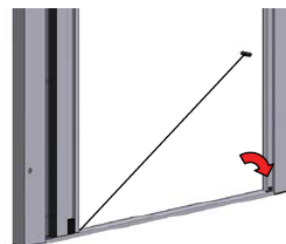

2.2.11. Insert wire node into the plastic block in upper profile and adjust the tension. The proper position of a block is approx. 1 cm from the side profile. If different then tie up the node.

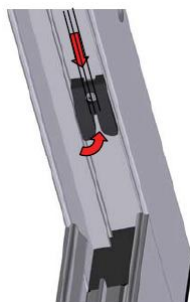

2.2.12. Test the polarity of the „magnet profile“ then fix it to the „arrival profile“.

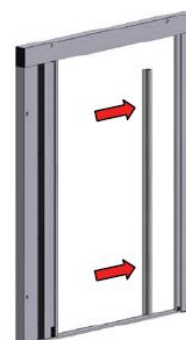

2.2.13. Open the screen mesh and check smooth movement.

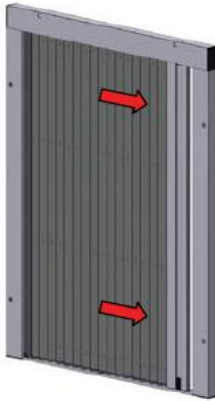

2.2.14. Insert the safety pin into the lower part of the frame KIT. For better sliding.

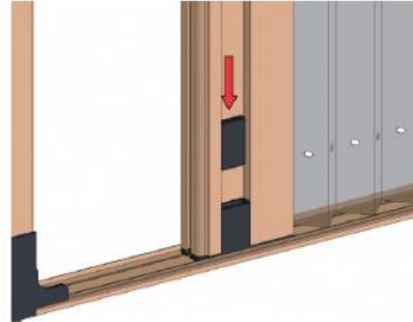

2.2.15. Insert the caps to cover the holes.

