

# OUTSIDE ROLLER-BLINDS VIVERA, PLASTERAX, STAKUSIT

## 1. CONTROL

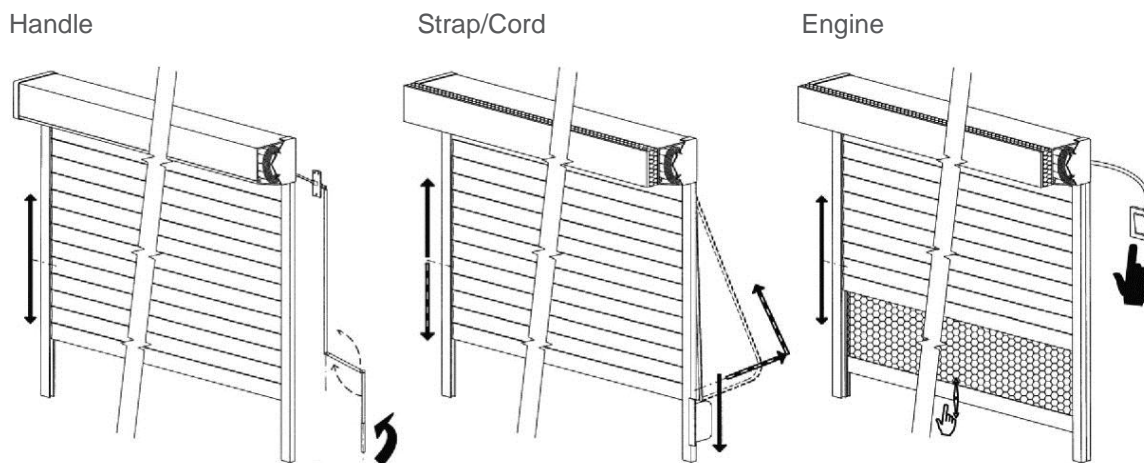

### DESCRIPTION OF THE CONTROL USING THE LEVER:

Grasp the lever, hold the lower part for better control and tilt the whole lever away from the wall. The blind is lifted by turning the lever in an upward direction and downward in the opposite direction. After the blind reaches the lower position, the lower bar is supported by the window sill. After manipulation, put the lever into the original position and fix the lever into the holder.

### DESCRIPTION OF CONTROL USING THE STRAP/CORD:

The blind is lifted by drawing the strap/cord in a downward direction to the roller. The strap/cord is automatically wound into the winding unit by the spring. The blind is lowered by drawing the strap/cord perpendicularly from the winding unit in the inward direction. The light holes are opened by slightly drawing the strap/cord into the winding unit.

### DESCRIPTION OF THE CONTROL USING THE ELECTRIC ENGINE:

Blinds can be lowered and rolled using the electric drive with the remote control unit or the switch. In the case of an electric drive, it is possible to use automatic control, such as the wind and solar sensor, depending on the weather. In this case, an engine with a remote control is required. To set the electric control of the blinds, follow the manual for this device that was delivered by the supplier.

## 2. MAINTENANCE

The product does not require any extraordinary maintenance or lubrication of control mechanisms.

During common cleaning regularly wipe the surface with a cloth or a wet soft textile or sponge. Only use soap solutions without chemical ingredients at a temperature of up to 30°C. Do not use aggressive detergents, such as organic solvents, cleaning sand, cleaning pastes, developing steams and strong alkali cleaning detergents. We recommend regularly inspecting and maintaining the blinds.

### REGULAR INSPECTION OF THE CONDITION.

- permanent functions of blinds (lifting and lowering),
- condition and rate of dirtying of blinds,
- wearing of control equipment,
- condition of guiding, guiding bars and unloader,
- correct function of end switches,
- noise level when running.

### NOTIFICATION:

Ensure careful cleaning of shading lamellas to prevent jamming or other damage.

When cleaning windows, set the product into a position to prevent damage and any interference while cleaning.

Protect the product against dirtying during reconstruction and painting.

## 3. Safety instructions

- Do not use force when handling the product if any obstacle prevents its motion.
- Do not attach any items to the product (particularly lamellas, control mechanisms).
- Prevent mechanical stress and damage to the product.
- For products controlled by cords, keep cords out of the reach of children to prevent entangling and jamming.
- Handle the product carefully, especially during cleaning.

### FOR PRODUCTS WITH MOTOR-DRIVEN DRIVES:

- To set the electric control of the product, follow the manual for this device that was delivered by the supplier.
- Do not allow children to play with the equipment. Keep the remote control out of the reach of children.
- Check the installation for damage to inlets.
- For the inspection or maintenance of electrical parts, the product must be disconnected in an appropriate manner from the electricity supply.

### NOTIFICATION:

Electrical installation, assembly and maintenance must only be performed by fully-qualified persons who are authorized and capable of the stated actions.

In the case of a defect or mechanical damage to the product, prevent any further use.

NOTES:

- If the product is not functional, contact the seller or the firm which assembled the product.
- The display of the product may slightly differ from the actual version. The producer reserves the right to make changes.
- After the termination of the service life, do not dispose of in communal waste. Materials used can be separated and handed over in accordance with the valid regulations on waste and environmental protection. Information on waste collection points can be obtained from the local administration office.