

V-LITE ROOF BLIND

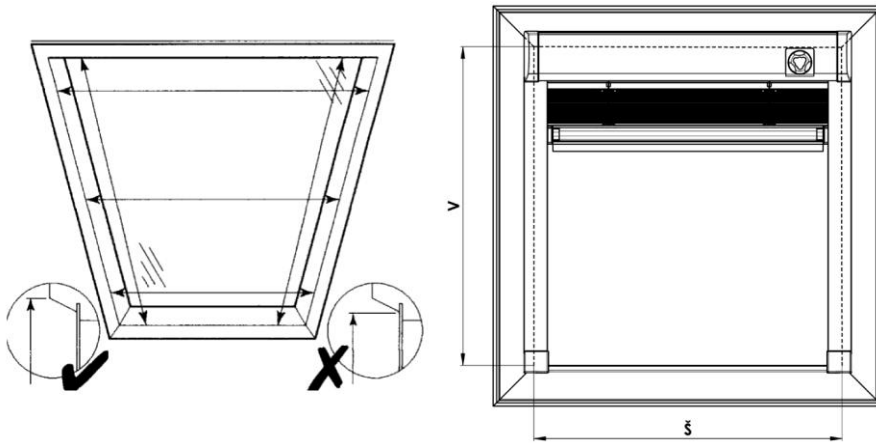

1. MEASUREMENT OF THE WINDOW:

Take measurements as indicated in the picture. Measurements are taken at the top of the frame of the window wing, not at the glazed area. The minimum depth for assembly is 40 mm.

THE WIDTH AND HEIGHT OF THE LIGHT HOLE IN THE WINDOW WING IS MEASURED IN THE FOLLOWING WAY:

w.... (width)

The measurement is from the left top to the right top of the window wing, up in the place of the roller blind fixation.

The width of the blind is produced in a precision of millimeters from the width 300 mm up to the width of 1200 mm.

It is recommended to consult with the manufacturer dimensions outside the stated limits.

h (height)

Measurements are taken in the same way as width, from the upper top to the lower top of the window wing and these are written into the order form of the blind.

The height of the blind is produced with a precision of millimeters from the height 300 mm up to the height 1200 mm.

It is recommended to consult with the manufacturer dimensions outside the stated limits, too.

IN THE ORDER FORM, IT IS NECESSARY TO SPECIFY:

1. dimension
2. type of window and identification number of the window
3. angle of the glazing bar (90°, 96°, 100°, 102°, 105°)

ATTENTION!

If the roof window does not have a model label and there is no possibility to state the angle of the glazing bar, it is necessary to mention this in the order form, in addition to the dimensions on the top of the frame, the dimensions for the

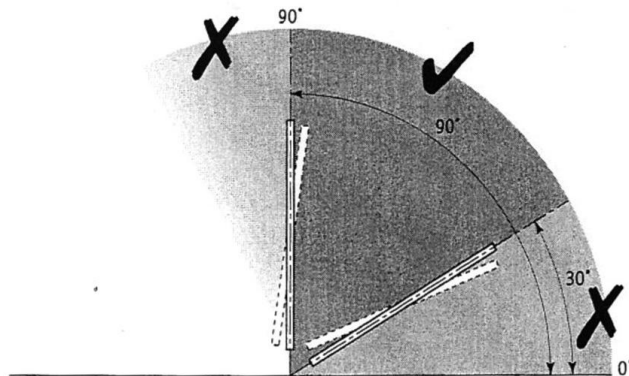

glass, including the depth of the window frame. The exact angle of the glazing bar of the frame of the roof window can be derived from these parameters.

ATTENTION!!! THE ANGLE OF THE ROOFDECLINATION MUST NOT BE LESS THAN 30° AND MORE THAN 90°.

2. ASSEMBLY

Assemble exactly according to this manual to prevent redundant assembly errors and other related problems.

AIDS FOR ASSEMBLY:

- electric drill
- cross-head screwdriver
- knife, scissors, pliers
- allen key 1,5
- for clip fixation: screw 3x17

CONTROL:

- before assembly we recommend to inspect all of the delivered parts of the goods to prevent any problems. The manufacturer must be notified of any defects or comments concerning the assembly of the blinds.
- never unfold the roof blind before assembly.
- remove all obstacles from the sky light that could prevent the assembly (plastic holders etc).



MEASUREMENT AND ASSEMBLY MANUAL

ASSEMBLY:

- ATTENTION! Do not remove the transport clips in any way!!!
- never unfold the roof blind before assembly.
- remove all obstacles from the sky light that could prevent the assembly.



FIXATION OF CEILING CLIPS:

- place the angle clip to the upper edge of the window wing in the distance which delimit the clip end stop itself (see picture one).
- screw and then break off the exceeding parts, which defined the assembly depth
- for plastic window use fore drilled holes – drill \varnothing 2mm.



FIXATION OF THE UPPER PROFILE:

- assembly bases of the clip must be pressed to the side boards of the roller blind (see picture two).
- catch the upper profile and slip it frontally on the angle ceiling clips to make the end stop click (see picture three).



GUIDING CHANNELS ASSEMBLY FOR BLINDS OPERATED BY WHEEL:

- insert the guiding channels under the upper profile, align them with the edge of the frame and screw them.



FIXATION OF THE STRETCHING CORDS:

- wind off the stretching cords from the transport clips on the blind and loosen them.
- ATTENTION! Do not remove the transport clips in any way!!!
- clamp the stretching holders located on the ends of cords into the lower ends of the guiding channels.

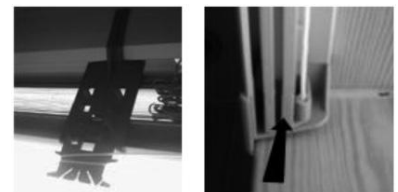

MEASUREMENT AND ASSEMBLY MANUAL

GUIDING CHANNELS ASSEMBLY FOR BLINDS OPERATED BY SLIDER:

- loose the cords from the transport clips.
- insert the operating slider from the top of the guiding channel before inserting guiding channels (see picture one).
- pay attention not to get the stretching cords or cord with slider between guiding channels and window frame.
- insert the leading bars under the upper profile, align them with the edge of the frame and screw them.

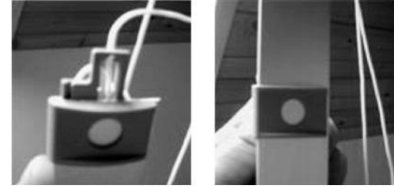

FIXATION OF THE CONTROL CORD FOR THE BLINDS OPERATED BY THE SLIDER:

- insert the loop of the cord of the control slider behind the wheel into the foot of the guiding channel.
- if the function of tilting the slats is incomplete, it is necessary to loosen or tighten the cord on the slider.



ADJUSTMENT OF THE BLIND BRAKE:

- if necessary, the brake of the blind can be adjusted by setting the stretching cords.
- adjust the brake by moving the metal roller on the end of the cord (allan key 1,5)
The following rule is always valid: the higher the stretching of the cord, the higher braking of the blind.
- the correctly adjusted brake holds the blind in any position when lifting.
- cut off the excess cord ends.



MEASUREMENT AND ASSEMBLY MANUAL

CENTRAL FIXATION:

- is implemented only in the case of wide blinds (width over 1000 mm).
- first lift the blind into the upper position.
- tighten the cord (nylon) for the central fixation so that it runs directly through the groove in the lower profile.
- mark on the window frame the position for the fixation of the window console and then screw it.

COMPLETION:

- remove paper adhesive tape from guiding channels ensuring the plastic stop of the slats.
- odstraníme přepravní klipy z žaluzie remove the transport clips from the blind.
- lower the blind into the lower part of the window by catching the lower bar. The plastic stops fit into the lower rail and the blind is prepared for successful use.

CONTROL OF THE BLIND:



**Demonstrative assembly of the roof
blind V-Lite (operated by wheel)**

DEMONSTRATIVE ASSEMBLY

The roof blind is installed in agreement with safety
elements of the norm EN 13120

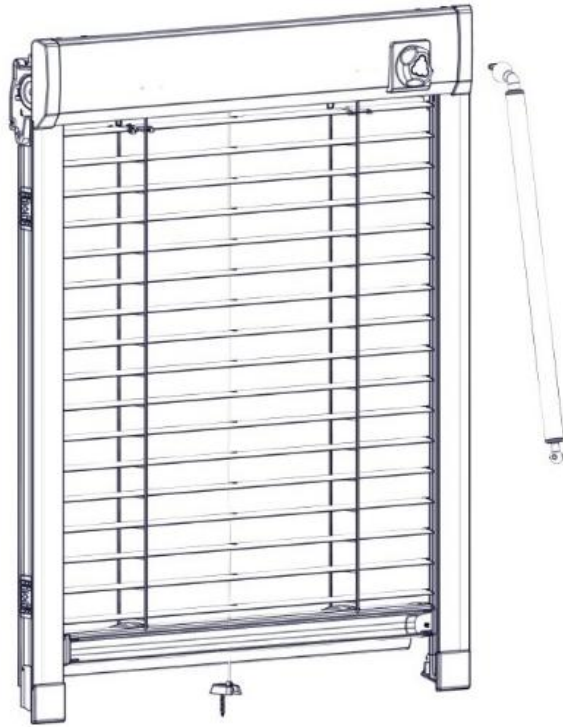
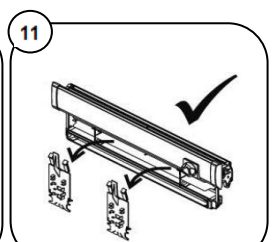
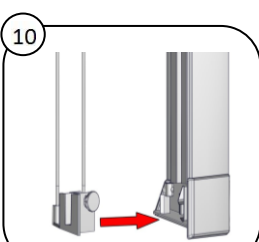
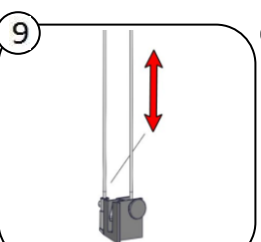
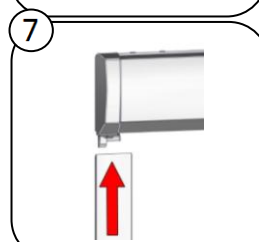
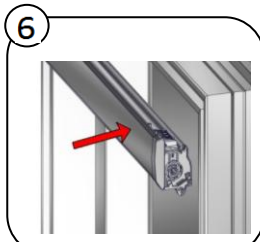
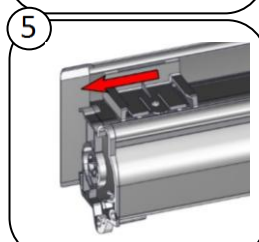
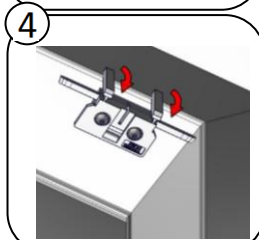
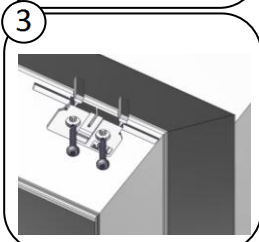
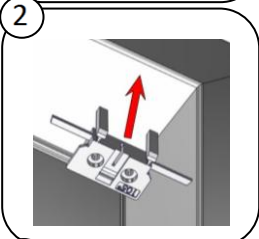
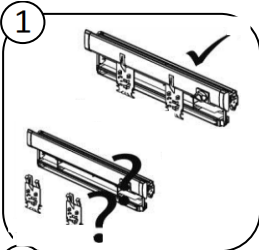
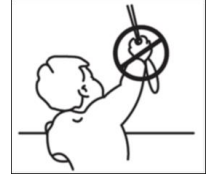

**Demonstrative assembly of the roof
blind V-Lite (operated by slider)**

The roof blind is installed in agreement with safety
elements of the norm EN 13120

DEMONSTRATIVE ASSEMBLY

